

# MR

## EXTERIOR BULKHEAD WALL MOUNTED / SURFACE MOUNTED

### FEATURES

- Vandal Proof Exterior Bulkhead.
- IP65 Rated.
- L75 B50@50,000.
- Die-cast Aluminium Body.
- Polycarbonate Diffuser.
- Silicone Gaskets.
- Integral control gear.
- Available with a security grill for extra protection.
- Eyelid option available (MR17 only).
- Black powder coat finish, other colours available on request.
- PLC available on request.



Specifications	
Diameter	260mm - MR13 360mm - MR17
Depth (Standard)	125mm - MR13 150mm - MR17

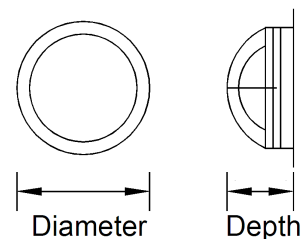

Technical Information		
Series	System Power	Board Output
MR13	15.3W	1500 (lm)
MR17	22.2W	2500 (lm)

### PRODUCT CODE

Example code: **MR17/GR/LED/40**

*Specifications subject to change without notice.*

Product Series	Size	Option	Type	Colour Temperature	ECG / Emergency Options
<b>MR</b>	<b>13</b> Small	<b>(Blank)</b> No cover	<b>LED</b>	<b>30</b> 3000K	<b>ME</b> Maintained Emergency (MR17 only)
	<b>17</b> Large	<b>GR</b> Grill		<b>40</b> 4000K	
		<b>EL</b> Eyelid (MR17 only)			

**FREND**  
lighting

phone 1300 241 087

fax (617) 3272 9000

email [sales@foslighting.com.au](mailto:sales@foslighting.com.au)

PO Box 268

14 Jaybel Street, Salisbury

Brisbane QLD 4107

[www.frend.com.au](http://www.frend.com.au)